



Universal Hand Lift

MOUNTING INSTRUCTIONS P/N: M93-30001

CUSTOMER MUST RECEIVE A COPY
OF THIS INSTRUCTION SHEET AT
THE TIME OF SALE

FOR QUESTIONS OR COMMENTS
PLEASE CALL: 763-689-4800

Item	Part #	Qty	Description
1a	2610-75	1	Lower Handle
1b	2610-76	1	Upper Handle
2	2610-71	1	Rear Crank
3	2610-72	1	Front Crank
4	2610-73	1	Push Rod
5	2610-5	2	Front Crank Clamp
6	2610-6	2	Front Crank Clamp Plate
7	2610-74	1	Push Rod Clevis
9	2610-9	1	Handle Stop
10	HDW2025	1	5/16" x 1" Socket Head Bolt
11	HDW2060	2	5/16" x 1-1/2" Hex Head Bolt
12	HDW2051	1	5/16" x 1" Hex Head Bolt
13	HDW2066	6	5/16" x 2-1/4" Hex Head Bolt
14	HDW2163	1	1/2" x 1-3/4" Shoulder Bolt
15	HDW2164	1	3/8" x 5/8" Shoulder Bolt
16	HDW2331	2	Snap on Axle Cap
17	HDW2338	2	1" x 3/4" ID Flanged Bushing
18	HDW2341	1	1 x 40" Nylock Utility Strap
19	HDW4102	1	1" Black Grip
20	HDW654	1	12" Chain w 5/16" Snap Hook
21	HDW7056	5	5/16" Flanged Nut
22	HDW7058	7	5/16" Nylock Nut
23	HDW7061	1	3/8" Nylock Nut
24	HDW7068	1	1/2" Jam Nut
25	HDW9002	8	5/16" Flat Washer
26	HDW9017	1	3/4" Flat Washer
27	HDW9029	1	3/8" Flat Washer
28	HDW2100	2	3/8" x 1" Hex Bolts
29	HDW7060	2	3/8" Flanged Nuts
30	2610-15	1	Spacer

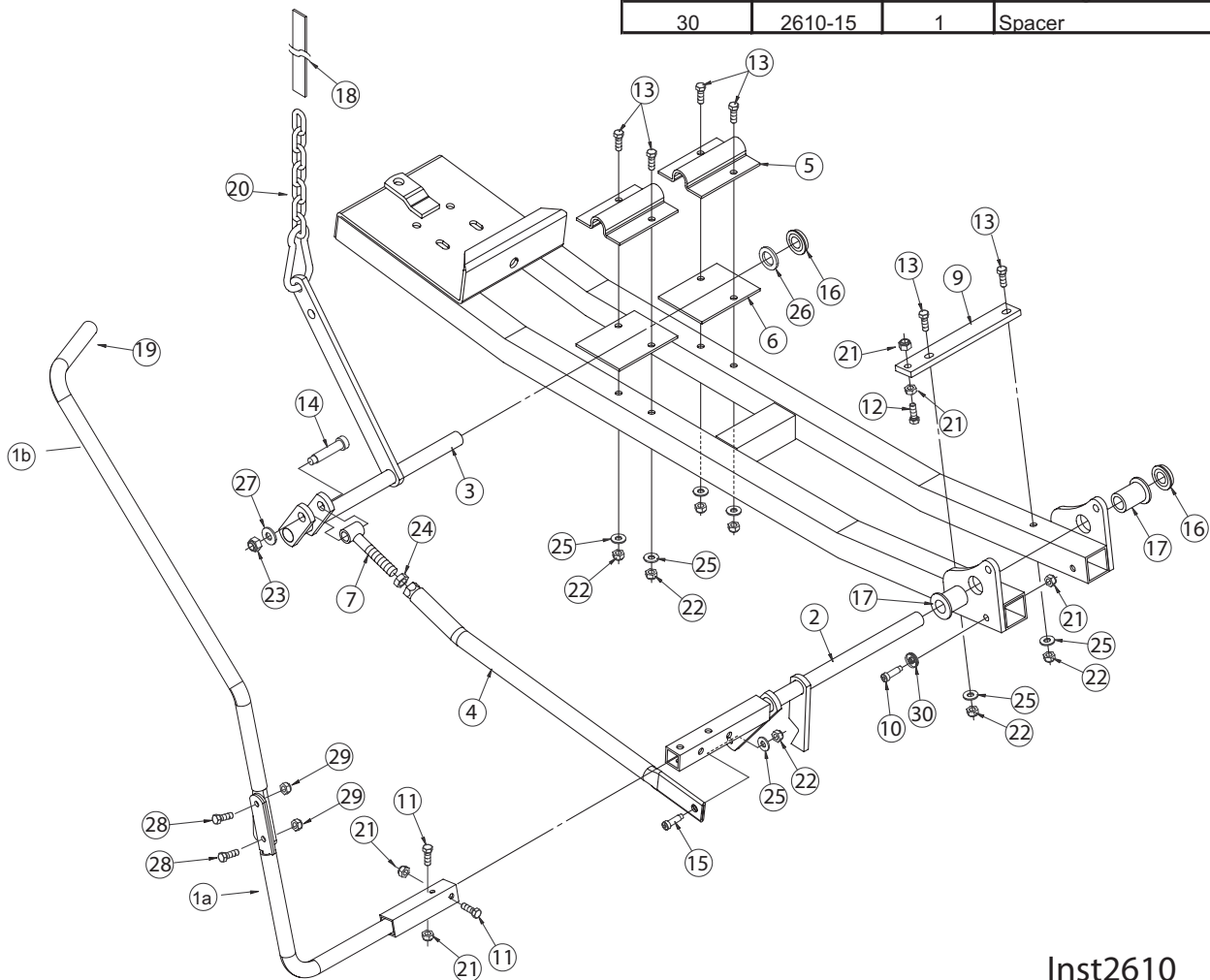

Universal Hand lift
Mounting Instructions

1. If the blade swivel has not been installed on the push tubes yet, install the swivel per the instructions included with the bottom mount.
2. Install the brass bushings (17) in the tabs at the back of the push tube. Push in from the outside of the tabs.
3. Install the 5/16" x 1" socket head bolt (10) and 5/16" flat washer (25) in the hole in the left (as you sit on the ATV) push tube mounting tab and install one 5/16" flanged nut (21) on the inside of the tube. Tighten firmly.
4. Install the rear crank (2) through the bushings per the diagram and tap one of the axle caps (16) onto the end of the shaft with a rubber mallet.
5. Install the handle stop (9) to the holes in the push tubes just in front of the mounting tabs with the extra hole in the handle stop hanging off the left side of the push tubes using two of the 5/16" x 2 1/4" bolts (13) and 5/16" flat washers (25) and 5/16" Nylock nuts (22). Tighten firmly. Install one 5/16" flanged nut (21) all the way onto the 5/16" x 1" hex head bolt (12) then install the bolt into the extra hole from underneath. Install another flanged nut onto the bolt. Do not tighten completely at this time.
6. Install the front crank (3) to the double set of holes in the push tube (in front of the cross brace) by placing the front crank clamp plates (6) on the tubes, greasing the insides of the front crank clamp plates (5) and sandwiching the front crank in between per the diagram. Make sure the long sides of the plates hang off the left sides of the tubes. Install the four remaining 2 1/4" bolts (13) from the top and install four 5/16" flat washers (25) and Nylock nuts (22). Tighten firmly.
7. Install the 3/4" flat washer (26) and tap the other axle cap (16) onto the end of the shaft.
8. Install the 1/2" jam nut (24) all the way onto the threads of the push rod clevis (7) and thread the clevis into the end of the push rod (4). We recommend applying thread lubricant to the threads before installing. Do not tighten the jam nut at this time.
9. With the lifting arm of the front crank positioned between the push tubes, install the push rod clevis between the tabs on the front crank. Install the 1 3/4" shoulder bolt (14) from the inside and install a 3/8" flat washer (27) and Nylock nut (23). Tighten firmly. Turn the push rod so the bend is facing down.
10. Attach the rear of the push rod to the lever arm on the rear crank using the 5/8" shoulder bolt (15) and a 5/16" flat washer (25) and Nylock nut (22). Do not tighten at this time.
11. Install the grip (19) onto the round end of the upper handle (1b) and assemble to the lower handle (1a) using the two 3/8" x 1" bolts (28) and flanged nuts (29) then install the handle onto the square tube on the rear crank using the two 1-1/2" hex head bolts (11) and two 5/16" flanged nuts (21). Install to the outer set of holes. The extra set of holes are provided if the handle needs to be moved inward after installation is completed.
12. Install the snap hook on the chain (20) into one of the holes in the lifting arm of the front crank. Lay the chain on the swivel. For easier lift put in lower hole of front crank.

Universal Hand lift
Mounting Instructions continued

13. Install the blade onto the swivel if it has not already been installed and place the whole assembly (blade, push tube and hand lift) with the handle on the left, in front of the ATV. Drive or push the ATV over the assembly.
14. Lift the rear of the assembly up and align the holes in the push tube mounting tabs with the bottom mount tabs and install the two wire loop pins included with the bottom mount.
15. Loop the utility strap (18) over the front rack and feed one end through a link in the chain. Feed the blank end through the friction clamp and snug up (not tight).
16. To adjust the handle so it will "cam over" or stay in place when it is pulled all the way back with the blade in the air, you will be adjusting the hex head bolt (12) on the handle stop (9) just in front of the rear crank on the left side. If the handle will not stay back (or "cam over"), you need to screw the bolt in from the bottom until the handle will stay in the full back position with the blade up. If the handle "cams over" but goes too far back and touches the rear fender or a rack, adjust the bolt out until the handle still "cams over" but stops short of rear fender. Tighten both jam nuts, top and bottom.
- 16a. If you have adjusted the bolt all the way and the handle still hits the fender or rack, loosen the lower bolt in the center of the handle and remove the upper one so the upper handle can be angled forward enough to miss the fender. Re-install the upper bolt and tighten both nuts.
- 16b. If your handle now goes too far forward, you can remove the bolt (10) from the left rear corner of the push tube and replace the washer (25) with the 1" diameter spacer (30) (not shown). This will stop the handle from going so far forward.
17. To adjust the lifting height you will be adjusting the push rod in or out of the clevis under the ATV. With the blade in the up position, measure the distance from the bottom of the blade to the ground. You will be adjusting the push rod in or out on the clevis until you have approximately 8-10" of blade ground clearance. Do this by first dropping the blade to the down position then removing the shoulder bolt at the back of the push tube and turning the push rod in or out. Be sure the bend in the rod is facing down, then reinstall the shoulder bolt, washer and nut. Lift the blade and re-measure the ground clearance. Once you have the ground clearance correct, be sure to tighten the rear shoulder bolt on the push rod and the jam nut on the clevis. Note: To bring handle more into the forward position (from rear fender) adjust the push rod clevis (7) all the way into the push rod (4). (Some models you may need to remove the 1/2" Jam nut (24).